

Battery Replacement & Operation of Electro Luminescent Clocks

IMPORTANT - READ THIS FIRST!

THIS EL BACK-LIT UNIT CONTAINS TWO SEPARATE BATTERIES

DO NOT push on the glass face when inserting the clock or thermometer into the holder / mount. Push on the chrome ring or bezel to insert. Make sure clock or thermometer is inserted all the way into holder / mount before riding or loss and / or damage may result. When the clock loses time or stops or the light no longer illuminates the batteries may be due for replacement. The batteries are accessible from the backside of the clock or thermometer. Your Clock will not require you to open it prior to a battery replacement. No other serviceable parts.

SETTING THE TIME & ACTIVATING THE BACK LIGHT (Fig.1): (a) The crown to adjust the time is located on the side of the unit at the Three o'clock position. To set the time, carefully pull the crown out and turn it until the desired time is show. Push crown back in to the normal position to restart the clock.. (b) The button to activate the back light for 5 seconds each push is located above the crown at the Two o'clock position. Push the button once to illuminate the dial for 5 seconds or hold it for constant illumination.

BATTERY REPLACEMENT:

<< CAUTION: DO NOT LIFT THE CLOCK MOVEMENT OUT OF THE CASE >>

NOTE: PREFORM THIS OPERATION OVER A TOWEL OR MAT SO PARTS DON'T GET LOST TO REMOVE YOUR CLOCK FROM THE HOLDER / MOUNT:

Take a sharp object like a pocket knife and put it gently into the departure line between the clock or thermometer and the holder / mount. Then pry the clock or thermometer up using a twisting motion so you can get a fingernail under it and lift it out. Perform this operation over a table with a towel as not to lose or drop the clock or thermometer on the floor and damage it.

(Fig.2) Clocks are manufactured with a screw on/off back cover. You may buy a back removal tool from us or use a needle nose pliers to easily remove and replace the back cover. A jeweler or watch band shop will also have a tool to remove the backing of the clock. The battery is retained in position by a tiny metal plate. Place the tools tips in the slots of the case back and unscrew counter-clockwise.

(Fig.3) Tools required to change batteries are a fine jeweler type phillips screw driver (for the back light battery only) and pointed tweezers or small needle nose pliers.

(Fig.4) Once screw back has been removed, use tweezers to remove round plastic retaining ring, note it's position for re-installation. (In later models the ring has been replaced with a small foam block.)

If only replacing the watch battery and not the back lighting battery (back light battery is the first visible) please skip to (fig.8).

(Fig.5) The back lighting battery is replaced by removing the very small phillips head screw at the end of the retaining bracket.

(Fig.6) Once the old battery is removed you may replace the battery with the same or equivalent number battery (CR2025) with positive pole (+) facing outward and reinstall the retaining bracket using the small phillips head screw.

(Fig.7) To reach the clock battery use a tweezers or small needle nose pliers to carefully remove the entire lighting assembly containing the large battery from the housing, being very careful not to lift the clock and face assembly out with it. These two parts are located to each other using a series of small molded prongs that may stick together. (you may have to gently pry the light assembly from the clock face assembly)

(Fig.8) Once the lighting assembly has been removed the clock mechanism and back side of the face is visible.

(Fig.9) The battery is retained in position by a tiny metal prong. You may just carefully pry up at the bottom of the battery to remove it. Be sure when replacing the battery to use the same number (SR626SW) or equivalent button cell, with positive pole (+) facing outward. Make sure it is replaced securely in position and under the small metal prong.

REPLACING ALL COMPONENTS AND SEALING THE CLOCK OR THERMOMETER:

After the batteries have been replaced and have checked to make sure the components are functioning properly you may reverse the previous steps to reassemble the unit. The case has a slot on the inside wall of the case at the twelve o'clock position, the white back light assembly has a matching tab that meets it to align the assembly inside the case. Make sure the three white prongs on the clock face that remains in the case is at the top with the center prong lined up with the slot on the inside case wall. When the center prong is in line with the slot you may re-insert the back light assembly and compress the parts together to lock them in place. Then re-insert the white retaining ring shown in (Fig.4) making sure the recessed areas around the inside of the ring line up and provide clearance for the four screws on the back of the back light assembly (one recess is just slightly off and will rest on one of the screws). Press the ring in place and reinstall the back of the case with spanner tool provided or the like. Note: Make sure the black O ring is properly set on the clocks back cover is in position and will form a satisfactory water tight seal and the case backing is not cross threaded.

Battery Replacement & Operation of Electro Luminescent Clocks

THIS EL BACK-LIT UNIT CONTAINS TWO SEPARATE BATTERIES

PLEASE VERIFY THIS IS THE WHITE EL UNIT YOU OWN BEFORE ANY MAINTENANCE PROCEDURE

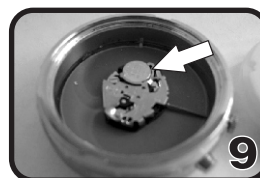
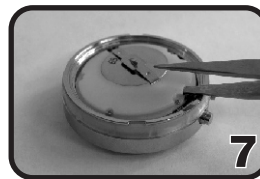
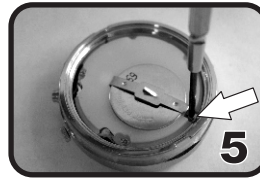
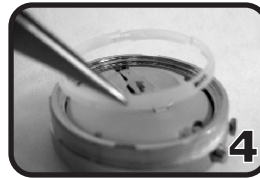
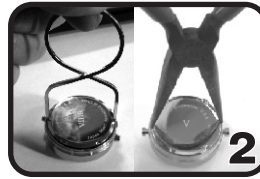
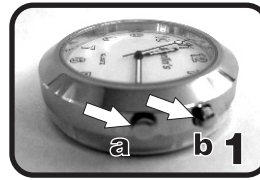

FACTS ABOUT THE COMPRESSION RING USED TO HOLD YOUR CLOCK OR THERMOMETER IN THE HOLDER / MOUNT:

When the clock or thermometer has been installed in the holder / mount for a long time and you remove it from the holder / mount to change the battery or other reason, the rubber compression ring may stay compressed. To avoid a loose fit put a fresh compression ring on the clock or thermometer (a spare should have been supplied with the purchase of your new Marlin's item). Note the compression rings position before removing it, the wide part of the nub molded into the ring should face up and to the out side of the clock or thermometer. To rejuvenate or expand the used compression ring back to it's original size, place it in very hot water for a minute or two, then put the ring in cold water and it will bring it back to shape for the next time you need to switch compression rings.

It is recommended when you take the clock or thermometer out of the holder/mount to use some isopropyl alcohol and clean the inside rim of the holder / mount were the clock or thermometer goes to eliminate any dirt or oils that could reduce the gripping power of the compression ring.

CHROME CARE:

The holder / mount and bezel can be polished and cared for with a quality chrome polish. Your new clock or thermometer is waterproof, shock resistant and the numbers may glow in the dark if so equipped. The face must be exposed to a light source before you ride to charge and activate the glow in the dark feature.

TO RE-INSERT YOUR CLOCK OR THERMOMETER INTO THE HOLDER/MOUNT:

You can moisten a paper towel with Windex or similar product (NO silicon or oil based product), then wipe it on the rubber ring around the clock to help you slide the clock in to the holder. (Allow the Windex or other product to dry completely before riding) Turn the clock in the position you like and push it in place, push inward on the chrome edges or bezel of the unit, making sure that the rubber ring is not stuck on the edge of the holder / mount, (you may use your fingernail or similar object to make sure the rubber ring is in place properly) and there is no gap so that the unit is firmly in place.

When replacing the clock or thermometer in the holder, press on the chrome bezel not the crystal / glass.

**ALL RETURNS MUST BE PACKED TO ELIMINATE DAMAGE
DAMAGED RETURNS WILL NOT BE ACCEPTED**

Enjoy your Marlin's Product
www.marlinlocks.com